

THE RECONNECTED WORKPLACE

Environmental Graphics: Beyond the Sign to Artful Design

As offices reopen, behavior changes will be helped along by explicit visual information on stickers and signage. More permanent, artful solutions for spatial awareness can complement these temporary overt cues. DLR Group interior design and environmental graphics teams joined forces to explore ideas that rely on human intuition, a touch of whimsy, and commonly available materials and products that will live on past the need for distancing. This fitness-oriented workplace shows how the central ideas are tailored to company brand and culture.

1



ENTRY

An app-controlled message board reassures employees and visitors with welcoming messages, plus “green lights” for occupancy within social distancing limits, sanitization, and symptom screening.

2



WALLS

Custom supergraphics at key communal and high-occupancy areas like desking use artistic real-life materials such as guitar cables and amps, carpenters pencils, and branded patterning to indicate six foot distances.

3

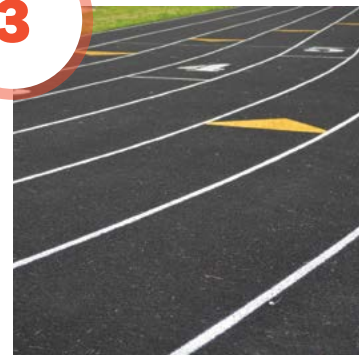

PATH

Track lane inspired graphics or flooring materials changes denote “lanes” for distanced travel.

4



BREAK ROOM

Invisible thermochroic coating on high-touch surfaces trigger disinfecting and personal hygiene actions. Floor graphics tied to company culture – one bike length, two golden retrievers nose-to-tail – help employees subconsciously distance during spontaneous conversations.

5

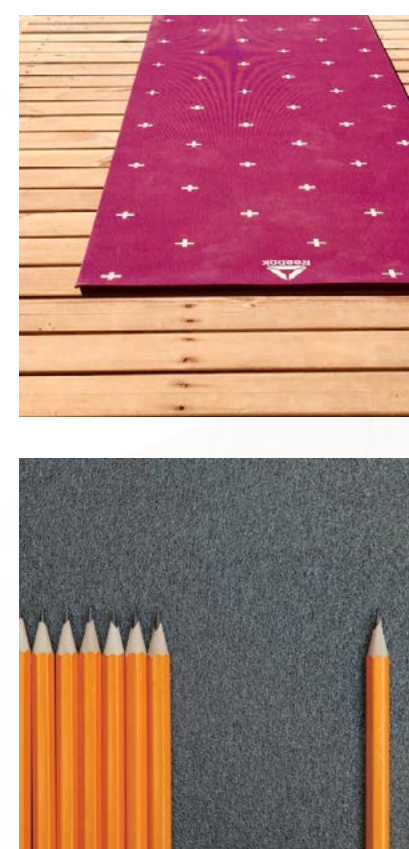
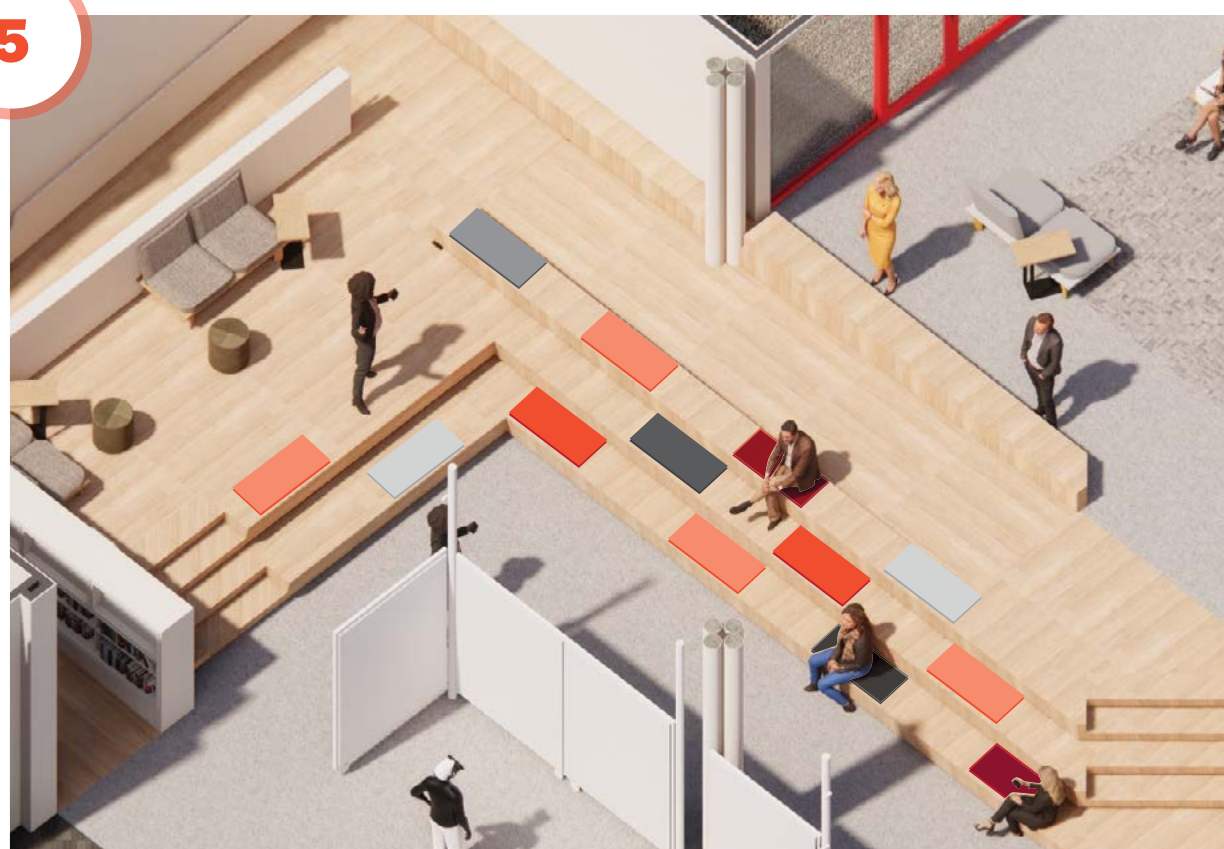

BLEACHERS

A standard yoga mat is just over 6’ long. Placing them along shared bleachers both encourages distanced seating and provides a comfortable resilient surface that is highly durable and cleanable.

A sculptural graphic line pattern on the wall, constructed of hundreds of carpenter’s pencils, reinforces the 6’ safety distance.

6

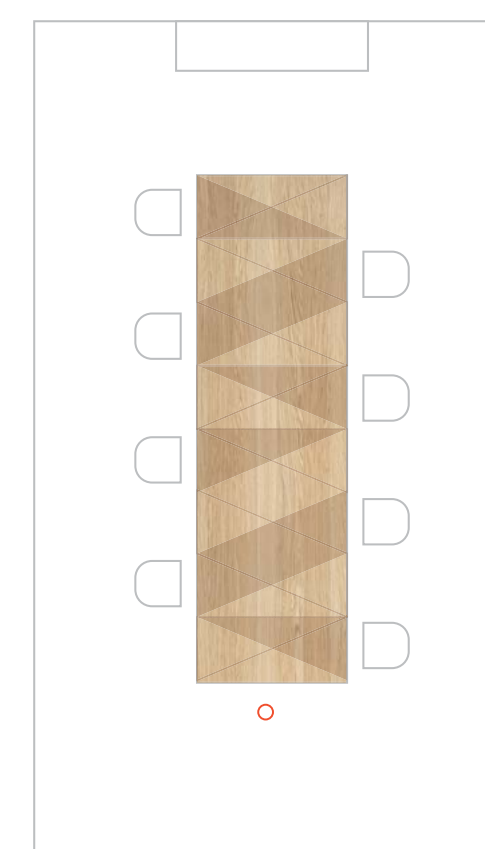
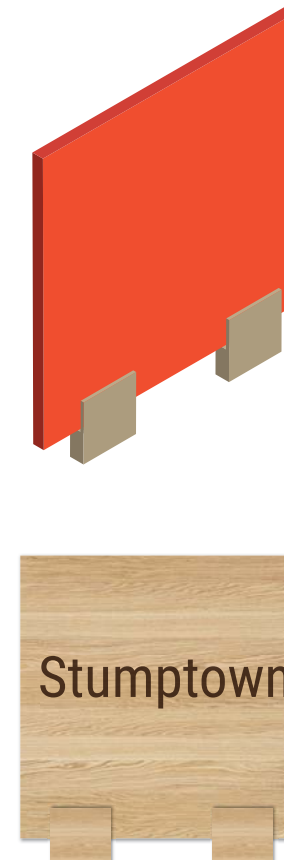

BOARD ROOM

The board room table features a subtle geometric pattern, from stain or species variation, which indicates distanced seating recommendations.

A double sided room sign indicates room sanitization – flip to indicate that the room needs cleaning. In the future, the same signage can be used to indicate usage.

